

# Blackpool Council

**APPLICATION TO VARY A PREMISES LICENCE**

<b><i>Applicant Name(s):</i></b>	Manohar Raisinghani
----------------------------------	---------------------

**Contact**

Licensing Service  
Blackpool Council  
Municipal Buildings, PO Box 4  
Blackpool, FY1 1NA

T: (01253) 47 8572 / 8589  
F: (01253) 47 8372

[www.blackpool.gov.uk](http://www.blackpool.gov.uk)



# Application to vary a Premises Licence under the Licensing Act 2003

Please read the following instructions first:

Before completing this form please read the guidance notes at the end of this form. If you are completing this form by hand please write legibly in block capitals. In all cases ensure that your answers are inside the boxes and written in black ink. Use additional sheets if necessary. You may wish to keep a copy of the completed form for your records.

Full name/s of the premises licence holder/s:	
1)	Manohar Raisinghani
2)	
3)	

I/We the premises licence holder/s named above, apply to vary a premises licence under section 34 of the Licensing Act 2003 for the premises described in Part 1

<b>Premises Licence number:</b>	PL1678
---------------------------------	--------

## Part 1 – Premises Details

<b>Premises Address</b>	The Albert Hotel, 117 Albert Road						
	Blackpool						
	<b>Post Code</b>	F	Y	1		4	P W
<b>Telephone Number of premises (if any)</b>	0779 00 66 344						
<b>Non-domestic rateable value of premises</b>	£9,500						

## Part 2 – Applicant details

<b>Title:</b>	Mr				Other	<b>Forename(s)</b>	Manohar																						
<b>Surname</b>	Raisinghani					<b>Date of Birth</b>	<table border="1"> <tr> <td>Day</td> <td>Month</td> <td>Year</td> </tr> <tr> <td></td> <td></td> <td></td> </tr> </table>	Day	Month	Year																			
Day	Month	Year																											
<b>Home address</b>	<div style="border: 1px solid black; width: 100px; height: 60px; margin-bottom: 5px;"></div>						<b>Post Code</b>	<table border="1"> <tr> <td></td><td></td><td></td><td></td><td></td><td></td><td></td><td></td><td></td><td></td><td></td><td></td><td></td><td></td><td></td><td></td><td></td><td></td><td></td><td></td> </tr> </table>																					
<b>Telephone Number</b>					<b>Mobile Number</b>	<table border="1"> <tr> <td></td><td></td><td></td><td></td><td></td><td></td><td></td><td></td><td></td><td></td><td></td><td></td><td></td><td></td><td></td><td></td><td></td><td></td><td></td><td></td><td></td> </tr> </table>																							
<b>E-Mail address</b>	<table border="1"> <tr> <td></td><td></td><td></td><td></td><td></td><td></td><td></td><td></td><td></td><td></td><td></td><td></td><td></td><td></td><td></td><td></td><td></td><td></td><td></td><td></td><td></td> </tr> </table>																												

**SECOND INDIVIDUAL APPLICANT (If Applicable)**

<b>Title:</b>				<b>Ms</b>	<b>Other</b>	<b>Forename(s)</b>			
<b>Surname</b>					<b>Date of Birth</b>	<b>Day</b>	<b>Month</b>	<b>Year</b>	
<b>Home address</b>					<b>Post Code</b>				
<b>Telephone Number</b>				<b>Mobile Number</b>					
<b>E-Mail address</b>									

**A. OTHER APPLICANTS**

Please provide name and registered address of applicant in full. Where appropriate please give any registered number. In the case of a partnership or other joint venture (other than a body corporate), please give the name and address of each party concerned.

<b>Name</b>									
<b>Address</b>					<b>Post Code</b>				
<b>Registered number</b>									
<b>Description of applicant (for example partnership, company, unincorporated association)</b>									
<b>Telephone number</b>									
<b>E-Mail address (optional)</b>									

### Part 3 – Variation

If yes please tick

Do you want the proposed variation to have effect as soon as possible?

If not, when do you want the variation to take effect from?

Day		Month		Year			

If your proposed variation would mean that 5,000 or more people could be expected to attend the premises at any one time, please state the number expected to attend

**Please describe briefly the nature of the proposed variation** (Please see guidance note 1)

The objective to the variation is to extend the Premises Licence to non-residents for the following purposes:

- 1) On the ground floor, it is intended to run a 'microbar' (along the same concept of a micropub) serving real ales direct from the cask, and bottled beers, fruit wines, small batch gin and whisky as well as non alcoholic refreshments such as coffee, minerals and cold bar snacks. The emphasis will be on local produce and small breweries. The bar will be in the main marketed to special interest groups such as CAMRA as well as hotel residents. There may be light/unamplified background music only during opening hours.

All activities listed below, (except for the sale of alcohol to non residents), will apply Only to the Lower Ground Floor bar:

- 2) To enable functions to take place throughout the year in the lower ground floor bar, such as birthday parties, wakes, weddings, company meetings and the like. These events include live entertainment, the playing of recorded music and karaoke with dancing.

Numbers attending:

Ground Floor Bar & Upper Floors: Maximum 55 (28 possible in bedroom areas.). Egress will be down the main staircase and out through the front door as per existing situation

Lower Ground Floor Bar: Maximum 75 (not including those on upper floors.) people in the bar area. Egress via steps at the front of the hotel, or the passage alongside the garage to the service road.

## Part 4 – Operating Schedule

Please complete those parts of the Operating Schedule below that would be subject to change if this application to vary is successful.

### Provision of regulated entertainment in the cellar bar:

If yes please tick

- a) A performance of a play (if ticking yes, fill in box A)
- b) An exhibition of a film (if ticking yes, fill in box B)
- c) An indoor sporting event (if ticking yes, fill in box C)
- d) Boxing or wrestling entertainment (if ticking yes, fill in box D)
- e) A performance of live music (if ticking yes, fill in box E)
- f) Any playing of recorded music (if ticking yes, fill in box F)
- g) A performance of dance (if ticking yes, fill in box G)
- h) Entertainment of a similar description to that falling within (e), (f) or (g) (if ticking yes, fill in box H)

**Provision of late night refreshment** (if ticking yes, fill in box I)

**Sale by retail of alcohol** (if ticking yes, fill in box J)

**In all cases complete boxes K, L, and M**

**A**

Plays Standard days and timings (please read guidance note 6)			Will the performance of a play take place indoors, outdoors or both – please tick accordingly (Please read guidance note 2)	Indoors	X
Day	Start	Finish		Outdoors	
Mon	14:00	23:00	Please give further details here (please read guidance note 3) Nothing currently planned	Both	
Tue	14:00	23:00			
Wed	14:00	23:00	State any seasonal variation for performing plays (please read guidance note 4) N/A		
Thu	14:00	23:00			
Fri	14:00	23:00	Non-standard timings. Where you intend to use the premises for the performance of plays at different times to those listed in the column on the left, please list (please see guidance note 5)		
Sat	14:00	23:00			
Sun	14:00	23:00			

## B

<b>Films</b> Standard days and timings (please read guidance note 6)			<b>Will the exhibition of films take place indoors, outdoors or both – please tick accordingly</b> (Please read guidance note 2)	<b>Indoors</b>	<b>X</b>
				<b>Outdoors</b>	
<b>Day</b>	<b>Start</b>	<b>Finish</b>		<b>Both</b>	
<b>Mon</b>	<b>14:00</b>	<b>23:00</b>	Please give further details here (please read guidance note 3)  Nothing currently planned		
<b>Tue</b>	<b>14:00</b>	<b>23:00</b>			
<b>Wed</b>	<b>14:00</b>	<b>23:00</b>	State any seasonal variation for the exhibition of films (please read guidance note 4)  N/A		
<b>Thu</b>	<b>14:00</b>	<b>23:00</b>			
<b>Fri</b>	<b>14:00</b>	<b>23:00</b>	Non-standard timings. Where you intend to use the premises for the exhibition of films at different times to those listed in the column on the left, please list (please see guidance note 5)		
<b>Sat</b>	<b>14:00</b>	<b>23:00</b>			
<b>Sun</b>	<b>14:00</b>	<b>23:00</b>			

## C

<b>Indoor sporting event</b> Standard days and timings (please read guidance note 6)			<b>Please give further details</b> (Please see guidance note 3)
<b>Day</b>	<b>Start</b>	<b>Finish</b>	
<b>Mon</b>			
<b>Tue</b>			
<b>Wed</b>			State any seasonal variations for indoor sporting events (please read guidance note 3)
<b>Thu</b>			
<b>Fri</b>			Non-standard timings. Where you intend to use the premises for indoor sporting events at different times to those listed in the column on the left, please list (Please see guidance note 5)
<b>Sat</b>			
<b>Sun</b>			

## D

<b>Boxing or wrestling entertainment</b> Standard days and timings (please read guidance note 6)			Will the boxing or wrestling entertainment take place indoors, outdoors or both – please tick accordingly (Please read guidance note 2)	Indoors	
Day	Start	Finish		Outdoors	
Mon			Please give further details here (please read guidance note 3)	Both	
Tue					
Wed			State any seasonal variation for boxing or wrestling entertainment (please read guidance note 4)		
Thu					
Fri			Non-standard timings. Where you intend to use the premises for boxing or wrestling entertainment at different times to those listed in the column on the left, please list (please see guidance note 5)		
Sat					
Sun					

## E

<b>Live music</b> Standard days and timings (please read guidance note 6)			Will the performance of live music take place indoors, outdoors or both – please tick accordingly (Please read guidance note 2)	Indoors	X
Day	Start	Finish		Outdoors	
Mon	14:00	00:00	Please give further details here (please read guidance note 3)  Live entertainment in the Lower Ground Floor bar including the playing of recorded music and karaoke with dancing.	Both	
Tue	14:00	00:00			
Wed	14:00	00:00	State any seasonal variation for performance of live music (please read guidance note 4)		
Thu	14:00	01:00		New Years Eve extension to 2 am For Bank Holidays that the hours on Sunday be extended until 1 am For Christmas Eve (when falls on a weekday) that the hours be extended until 1 am	
Fri	14:00	01:00	Non-standard timings. Where you intend to use the premises for the performance of live music at different times to those listed in the column on the left, please list (please see guidance note 5)		
Sat	14:00	01:00			
Sun	14:00	00:00			

**F**

<b>Recorded music</b> Standard days and timings (please read guidance note 6)			<b>Will the performance of recorded music take place indoors, outdoors or both – please tick accordingly</b> (Please read guidance note 2)	<b>Indoors</b>	<b>X</b>
				<b>Outdoors</b>	
<b>Day</b>	<b>Start</b>	<b>Finish</b>		<b>Both</b>	
<b>Mon</b>	<b>12:00</b>	<b>12:00</b>	<b>Please give further details here</b> (please read guidance note 3)		
<b>Tue</b>	<b>12:00</b>	<b>12:00</b>	Amplified music in the Lower Ground Floor bar		
<b>Wed</b>	<b>12:00</b>	<b>12:00</b>	<b>State any seasonal variation for playing recorded music</b> (please read guidance note 4)		
<b>Thu</b>	<b>12:00</b>	<b>01:00</b>	New Years Eve extension to 2 am in the cellar bar. For Bank Holiday Sundays that the hours on Sunday be extended until 1 am For Christmas Eve (when falls on a weekday) that the hours be extended until 1 am		
<b>Fri</b>	<b>12:00</b>	<b>01:00</b>	<b>Non-standard timings. Where you intend to use the premises for the playing of recorded music at different times to those listed in the column on the left, please list</b> (please see guidance note 5)		
<b>Sat</b>	<b>12:00</b>	<b>01:00</b>			
<b>Sun</b>	<b>12:00</b>	<b>12:00</b>			

**G**

<b>Performances of dance</b> Standard days and timings (please read guidance note 6)			<b>Will the performance of dance take place indoors, outdoors or both – please tick accordingly</b> (Please read guidance note 2)	<b>Indoors</b>	
				<b>Outdoors</b>	
<b>Day</b>	<b>Start</b>	<b>Finish</b>		<b>Both</b>	
<b>Mon</b>			<b>Please give further details here</b> (please read guidance note 3)		
<b>Tue</b>					
<b>Wed</b>			<b>State any seasonal variation for the performance of dance</b> (please read guidance note 4)		
<b>Thu</b>			<b>Non-standard timings. Where you intend to use the premises for the performance of dance at different times to those listed in the column on the left, please list</b> (please see guidance note 5)		
<b>Fri</b>					
<b>Sat</b>					
<b>Sun</b>					



<b>Anything of a similar description to that falling within (E), (F) or (G)</b>  Standard days and timings (please read guidance note 6)			Please give a description of the type of entertainment you will be providing					
			Will this entertainment take place indoors, outdoors or both – please tick accordingly (Please read guidance note 2)		<table border="1"> <tr> <td><b>Indoors</b></td> <td></td> </tr> <tr> <td><b>Outdoors</b></td> <td></td> </tr> <tr> <td><b>Both</b></td> <td></td> </tr> </table>	<b>Indoors</b>		<b>Outdoors</b>
<b>Indoors</b>								
<b>Outdoors</b>								
<b>Both</b>								
<b>Day</b>	<b>Start</b>	<b>Finish</b>	Please give further details here (please read guidance note 3)					
<b>Mon</b>								
<b>Tue</b>			State any seasonal variation for entertainment of a similar description to that falling within (e), (f) or (g) (please read guidance note 4)					
<b>Wed</b>								
<b>Thu</b>			<b>Non-standard timings. Where you intend to use the premises for the entertainment of similar description to that falling within (e), (f) or (g) at different times to those listed in the column on the left, please list</b> (please see guidance note 5)					
<b>Fri</b>								
<b>Sat</b>								
<b>Sun</b>								

<b>Late night refreshment</b> Standard days and timings (please read guidance note 6)			Will the provision of late night refreshment take place indoors, outdoors or both – please tick accordingly (Please read guidance note 2)				
			<table border="1"> <tr> <td><b>Indoors</b></td> <td></td> </tr> <tr> <td><b>Outdoors</b></td> <td></td> </tr> <tr> <td><b>Both</b></td> <td></td> </tr> </table>		<b>Indoors</b>		<b>Outdoors</b>
<b>Indoors</b>							
<b>Outdoors</b>							
<b>Both</b>							
<b>Day</b>	<b>Start</b>	<b>Finish</b>	Please give further details here (please read guidance note 3)				
<b>Mon</b>							
<b>Tue</b>			State any seasonal variation for the provision of late night refreshment (please read guidance note 4)				
<b>Wed</b>							
<b>Thu</b>			<b>Non-standard timings. Where you intend to use the premises for the provision of late night refreshment at different times to those listed in the column on the left, please list</b> (please see guidance note 5)				
<b>Fri</b>							
<b>Sat</b>							
<b>Sun</b>							

**J**

<b>Supply of alcohol</b> Standard days and timings (please read guidance note 6)			<b>Will the sale of alcohol for consumption be on the premises, off the premises or both</b> (Please read guidance note 7)	<b>On the Premises</b>	<b>X</b>
<b>Day</b>	<b>Start</b>	<b>Finish</b>		<b>Off the premises</b>	
<b>Mon</b>	<b>12:00</b>	<b>24:00</b>	<b>State any seasonal variation for the supply of alcohol</b> (please read guidance note 4)  New Years Eve an extension until 2 am Bank Holiday Sundays an extension until 1 am Christmas Eve an extension until 1 am  These hours apply to non-residents only. Sale of alcohol will remain 24 hours for residents and will be subject to sight of room key.	<b>Both</b>	
<b>Tue</b>	<b>12:00</b>	<b>24:00</b>			
<b>Wed</b>	<b>12:00</b>	<b>24:00</b>			
<b>Thu</b>	<b>12:00</b>	<b>01:00</b>			
<b>Fri</b>	<b>12:00</b>	<b>01:00</b>			
<b>Sat</b>	<b>12:00</b>	<b>01:00</b>			
<b>Sun</b>	<b>12:00</b>	<b>24:00</b>			
			<b>Non-standard timings. Where you intend to use the premises for the supply of alcohol at different times to those listed in the column on the left, please list</b> (please see guidance note 5)		

**K**

**Please highlight any adult entertainment or services, activities, other entertainment or matter ancillary to the use of the premises that may give rise to concern in respect of children** (please read guidance note 8)

<b>Hours premises are open to the public</b> Standard days and timings (please read guidance note 6)			<b>State any seasonal variations (please read guidance note 4)</b>  These hours apply to non residents only. Sale of residents will remain 24 hours and be subject to sight of room key.
<b>Day</b>	<b>Start</b>	<b>Finish</b>	<b>Non-standard timings. Where you intend to use the premises to be open to the public at different times to those listed in the column on the left, please list (please see guidance note 5)</b>  New Years Eve an extension until 2 am Bank Holiday Sundays an extension until 1.20 am Christmas Eve an extension until 1.20 am
Mon	12:00	24:20	
Tue	12:00	24:20	
Wed	12:00	24:20	
Thu	12:00	01:20	
Fri	12:00	01:20	
Sat	12:00	01:20	
Sun	12:00	24:20	

**Please identify those conditions currently imposed on the licence that you believe could be removed as a consequence of the proposed variation you are seeking**

Annex 2: Item 1: Intoxicants to be served to residents only  
to be removed

I have enclosed the existing premises licence and summary If yes please tick

I have enclosed the relevant part of the premises licence

If you have not ticked one of these boxes you are required to give your reasons for not including the licence, or any part of it below.

**Reasons why I have failed to enclose the premises licence or relevant part of the premises licence**

Describe any additional steps you intend to take to promote the four licensing objectives as a result of the proposed variation:

**a) General – all four licensing objectives (b,c,d,e)** (See guidance note 9)

We shall apply all the mandatory conditions as laid down in the existing licence.

In addition, the Lower Ground Floor Bar will not be available for walk in customers to purchase alcohol except when a) private functions booked for specific purposes such as weddings, birthdays etc and/or b) specific theme events such as sixties evenings, country & western etc. For items a) and b) access will be via the front staircase. At other times access will be from the hotel only and service will be for residents and their friends at the hotel's discretion.

~~As a result we expect tight control to be exercised over who is drinking in the bar and for special~~  
As a result we expect tight control to be exercised over who is drinking in the bar and for special events the consumption of alcohol will be only part of the reason for attending due to interest in the evening's theme.

With regard to the ground floor bar, it is intended to run a "microbar" along the same concept of a micro-pub serving real ales direct from the cask, bottled beers, small batch gin and whisky as well as non alcoholic refreshments such as coffee, minerals and light bar snacks. This will create an environment akin to a licensed continental café and an environment where problems are less likely.

**b) The prevention of crime and disorder**

CCTv system to discourage criminal activities

Refusal to sell alcohol to drunk or intoxicated customers  
Clear outside notices indicating hours of operation

Any resident requesting a drink after the end of the public hours will have to produce their room key to be served.

**c) Public Safety**

External lighting to be positioned to promote public safety objectives  
Rigorous implements of under age ID checks  
Premises fittings and apparatus will be kept in good order and safe condition at all times

**d) The prevention of public nuisance**

Noise reduction measures to address the public nuisance objective

Clear and legible signs will be displayed at exits requesting customers to respect the needs of nearby residents especially when leaving the premises.

Customers will be asked not to stand around talking loudly in the street outside the premises.

Adequate waste receptacles for use for customers will be provided.

e) protection of children from harm

Challenge25 signs will promote the policy to ensure that anyone who is over18 but looks under 25 has acceptable ID. This includes an ID card with a pass hologram, a photographic driving licence or a passport to be shown if they wish to buy alcohol.

If yes please tick

- I have made or enclosed payment of the fee
- I have sent copies of this application, a copy of the plan and a photocopy of the existing premises licence to responsible authorities and others where applicable
- I understand that I must advertise my application
- I have enclosed the premises licence or relevant part of it or an explanation why not
- I understand that if I do not comply with the above requirements my application will be rejected

**IT IS AN OFFENCE, LIABLE ON CONVICTION TO A FINE UP TO LEVEL 5 ON THE STANDARD SCALE, UNDER SECTION 158 OF THE LICENSING ACT 2003 TO MAKE A FALSE STATEMENT IN OR IN CONNECTION WITH THIS APPLICATION**

**Part 5 – Signatures** (please read guidance note 10)

Signature of applicant (the current premises licence holder) or applicant's solicitor or other duly authorised agent (please read guidance note 11). If signing on the behalf of the applicant please state in what capacity.

Signed	
Print Name	M. RANSOME
Capacity	OWNER
Date	

Where the premises licence is jointly held signature of 2<sup>nd</sup> applicant (the current premises licence holder) or 2<sup>nd</sup> applicant's solicitor or other authorised agent (please read guidance note 12). If signing on behalf of the applicant please state in what capacity.

Signed	
Print Name	
Capacity	
Date	

Contact name (where not previously given) and address for correspondence associated with this application. (Please read guidance note 13)									
Title:			Miss		Other				
Forenames	Jennie Marie				Surname	Ransome			
Address for Correspondence associated with this application	The Albert Hotel								
	117 Albert Road								
	Blackpool				Post Code	F	Y	1	
Telephone Number					Mobile Number	<input type="text"/>			
E-Mail Address	<input type="text"/>								

SD - Smoke Detector, FE - Fire Extinguisher, EL - Emergency Lighting, X - Emergency Exit, FP - Fire Alarm Point, K - Klaxon

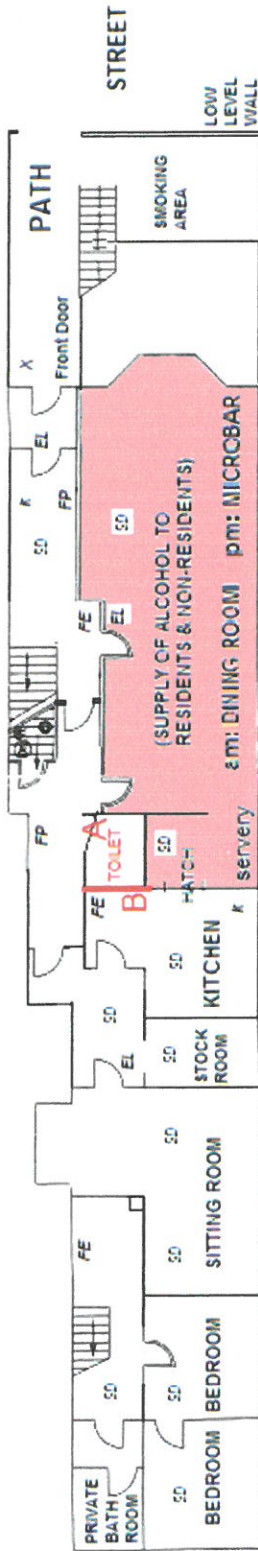

GROUND FLOOR

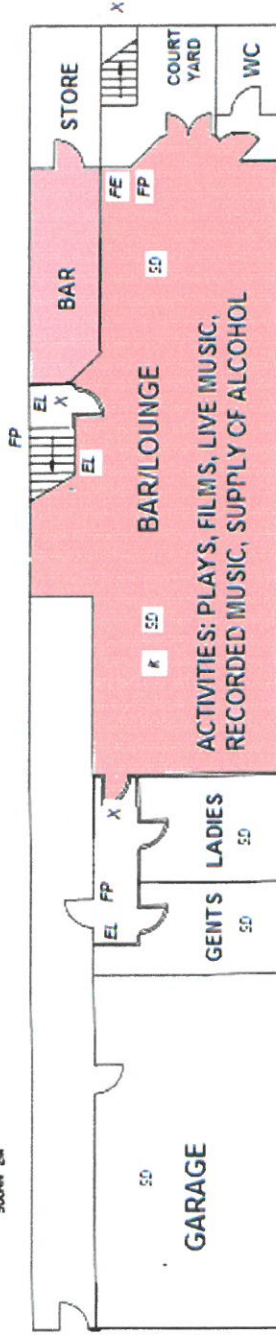
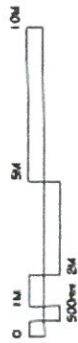

LOWER GROUND FLOOR

B - New Stud Wall to create an ambulant toilet. A - Sealed door reopened to allow access to new toilet

Shaded area is proposed licensed area for non-residents; residents licensed area as before.

Plans revised 8th June 2016

*Alan* *Edward* *15/6/16* *KS 405*

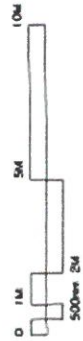

OCCUPIER	ALBERT HOTEL
ADDRESS	117 ALBERT RD BLACKPOOL
DATE DRAWN	10/4/01
CERT DATE	
FILE NO	30A1359
SCALE	1:125
DRWN BY	KS 405
DRWG NO	1 of 2

### **Overview**

The plans are essentially the same as previously submitted. The only significant change is that toilet facilities will be added on both the ground and lower floors.

The perimeter of the licensed premises will be reduced to part of the ground floor and the entire lower ground floor.

### **Licensed area**

On the ground floor, the licensed area is deemed to be the dining room plus the servery.

### **Licensable activities**

All licensable activities other than sale of alcohol will be performed in the lower ground floor area.

### **Stage**

There will be no raised areas or stages on either floor.

### **Fire safety**

The hotel has submitted a fire risk assessment for the hotel and this will be revised in the light of the revised licence.

### **Ground floor toilet**

The intention is to build a stud wall in a disused part of the kitchen area, open the blocked door from the passage and create a unisex ambulant toilet for use. The building regulations dept has confirmed that an opening outward door is impractical but all other regulations regarding ambulant toilets will be adhered to. This toilet will be for the use of people using the microbar and the dining room on the ground floor.

### **Toilets – lower ground floor**

Currently there is a unisex wc at the front of the lounge area.

At the rear of the lounge area there is a substantial storage area which it is intended to convert into ladies and gents toilets, conforming in their entirety to Ambulant Disabled Toilets Regulations (Building Regulations Part M 2004)

8<sup>th</sup> June 2016